

### Technical Dimensions (mm)

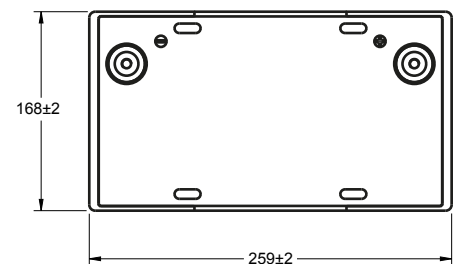

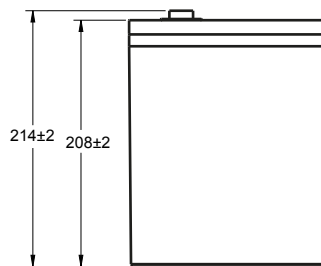

Image

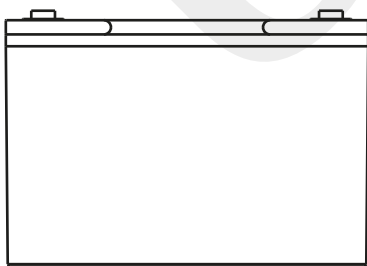

Terminal Dimensions (mm)

Standard Terminal: F6

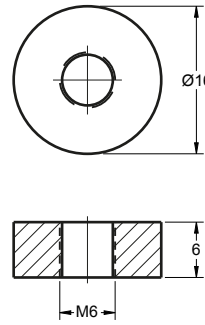

Optional Terminal: F14

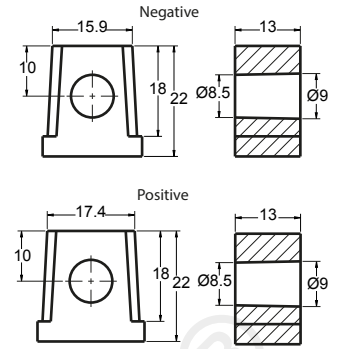

Technical Specification

<b>Output</b>	Nominal Voltage	12V
	Nominal Capacity (10HR)	75Ah
<b>Terminal Type</b>	Standard Terminal	F6
	Optional Terminal	F14
<b>Container Material</b>	Standard Option	ABS
	Flame Retardant Option (FR)	ABS (UL94:VO)
<b>Rated Capacity</b>	(100HR 1.80V/cell, 25°C)	86 Ah/0.86A
	(20HR 1.80V/cell, 25°C)	77.2 Ah/3.86A
	(10HR 1.80V/cell, 25°C)	75 Ah/7.5A
	(5HR 1.75V/cell, 25°C)	64 Ah/12.8A
	(3HR 1.75V/cell, 25°C)	55.5 Ah/18.5A
	(1HR 1.60V/cell, 25°C)	44.8 Ah/44.8A
<b>Max Discharge Current</b>	900A (5s)	
<b>Internal Resistance</b>	Approx 6.6mΩ	
<b>Discharge Characteristics</b>	Operating Temp Range	Discharge: -15 ~ 50°C Charge: 0 ~ 40°C Storage: -15 ~ 50°C
	Nominal Operating Temp Range	25 ± 3°C
	Cycle Use	Initial Charging Current less than 22.5A. Voltage 14.4V ~ 15.0V @ 25°C Temp. Coefficient -30mV/°C
	Standby Use	No limit on initial charging current. Voltage 13.5V ~ 13.8V @ 25°C Temp. Coefficient -20mV/°C
	Capacity affected by Temperature	40°C 103% 25°C 100% 0°C 86%
<b>Design Floating Life at 20°C</b>	15 Years	

Self Discharge

Ultracell® UCG batteries may be stored for up to 6 months at 25°C and then a refresh charge is required. For higher temperatures the time intervals will be shorter.

Constant Current Discharge / Constant Power Discharge At 25°C (Amperes & Watts/Cell)

A = Amperes W = Watts

F.V/TIME	5 min	10 min	15 min	20 min	30 min	45 min	60 min	2 hours	3 hours	4 hours	5 hours	6 hours	8 hours	10 hours	20 hours
<b>1.85V/cell</b>	120.9	95.1	80.8	67.6	53.4	40.6	33.6	21.3	16.6	13.6	11.6	10.1	8.21	6.96	3.75
<b>1.80V/cell</b>	222.8	177.0	152.0	128.4	102.4	78.4	65.1	41.6	32.4	26.7	22.8	19.9	16.3	13.8	7.46
<b>1.75V/cell</b>	159.9	119.7	96.3	78.8	61.5	46.1	37.4	23.2	17.8	14.5	12.5	10.8	8.76	7.50	3.86
<b>1.70V/cell</b>	291.8	220.4	178.7	147.5	116.4	88.3	72.0	45.0	34.7	28.3	24.4	21.3	17.3	14.9	7.67
<b>1.65V/cell</b>	184.0	134.2	107.3	86.5	65.5	48.7	39.5	24.3	18.5	15.0	12.8	11.1	8.91	7.58	3.90
<b>1.60V/cell</b>	328.4	243.0	196.6	160.3	123.0	92.5	75.8	46.9	35.8	29.2	24.9	21.8	17.6	15.0	7.73
<b>1.55V/cell</b>	205.1	148.0	115.9	92.0	69.1	51.1	41.2	25.5	19.1	15.5	13.1	11.4	9.03	7.61	3.98
<b>1.50V/cell</b>	355.1	261.4	209.1	168.9	128.8	96.6	78.8	49.1	36.9	30.0	25.5	22.2	17.8	15.1	7.88
<b>1.45V/cell</b>	223.9	158.2	122.1	96.7	72.4	52.7	42.7	26.2	19.8	15.9	13.4	11.6	9.17	7.69	4.01
<b>1.40V/cell</b>	381.6	276.3	218.1	176.0	133.7	98.7	81.1	50.1	38.2	30.8	26.0	22.7	18.0	15.2	7.94
<b>1.35V/cell</b>	249.0	173.2	131.6	103.9	77.0	55.7	44.8	27.2	20.5	16.3	13.7	11.9	9.28	7.82	4.05
<b>1.30V/cell</b>	414.5	295.5	231.2	187.0	140.9	103.7	84.5	51.7	39.3	31.4	26.4	23.1	18.2	15.4	8.00

**Discharge Characteristics**

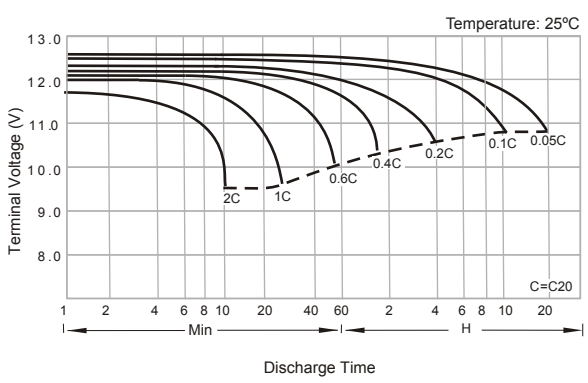

**Float Charging Characteristics**

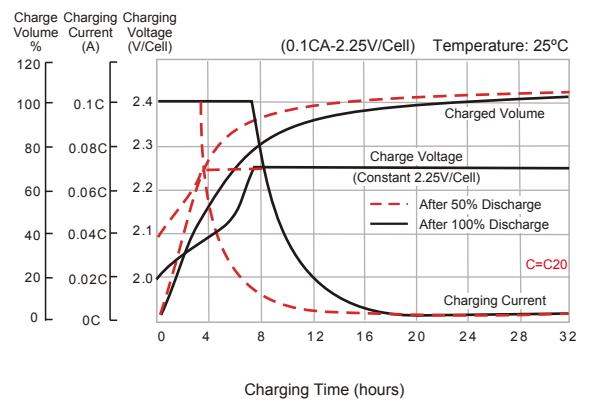

**Temperature Effects in Relation to Battery Capacity**

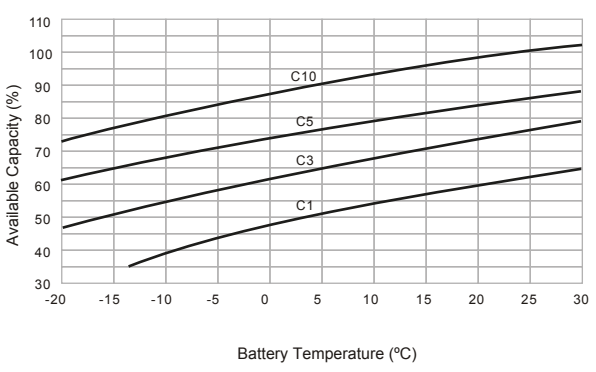

**Effect of Temperature on Long Term Float Life**

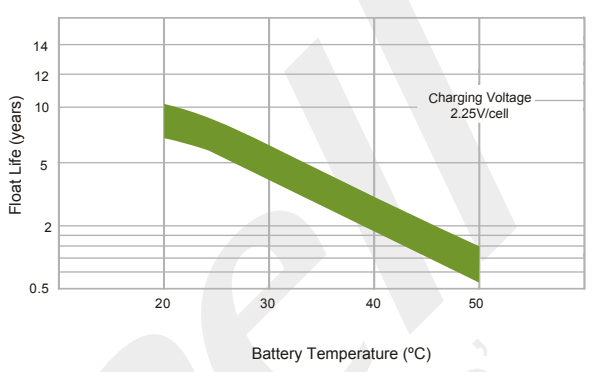

**Cycle Life in Relation to Depth of Discharge**

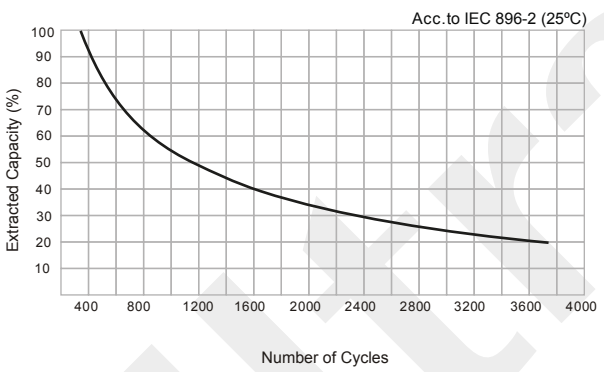

**General Relation of Capacity vs. Storage Time**

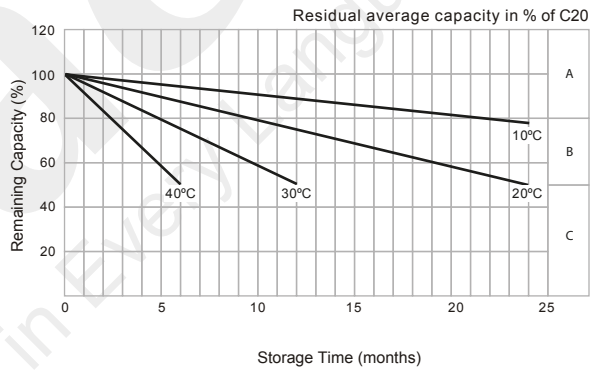

**General Relation of Capacity vs. Storage Time (Notes)**

- A) No supplementary charge required.  
(Carryout supplementary charge before use if 100% capacity is required.)
- B) Supplementary charge required before use. Optional charging way as below:
  1. Charged for above 3 days at limited current 0.25CA and constant voltage 2.25V/cell.
  2. Charged for above 20 hours at limited current 0.25CA and constant voltage 2.25V/cell.
  3. Charged for 8 ~ 10 hours at limited current 0.05 CA.
- C) Supplementary charge may often fail to recover the capacity.  
The battery should never be left standing till this is reached.

