

GRP PANELS

20 x 30 x 12 GRP Electrical Panel

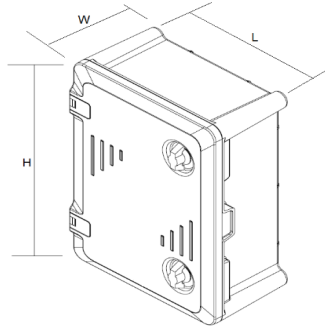

GENERAL SPECIFICATIONS

Raw Material	Glass Reinforced Polyester
Quality Standart	EN61439, EN60670-1
Color	RAL 7035
Operating Temperature	-40°C / +70°C
Rated Voltage	Up to 690 V
Maximum Current	Up to 800 A
Door Opening Angle	210°
Protection Class	IP65
IK Degree	Up to IK08
Mounting Plate	Galvanised Steel
Grounding Class	Class II
Fire Resistance	V0,V2,B2,A1,A2,B1 available

ADDITIONAL SPECIFICATIONS

Polyurathane Foam Gasket or EPDM Gasket
High Resistance Adverse Weather Conditions
Full Protection Against Acid and Base
UV Resistance
Lock types are optional

APPLICATIONS

Transformer Load Boards	Automation Panels
Compensation Boards	Control Panels
Distribution Boards	Lighting Panels
Network Generator	OSOS Panels
Transfer Applications	Counter Panels

PHYSICAL SPECIFICATIONS

Size	Code	W (mm)	H (mm)	L (mm)	Quantity / Pack	Volume (m ³)	Weight (kg)
20 x 30 x 12	EB6203012	120	300	200	8	0,071	28,4

PRODUCT SPECIFICATIONS

Size	Hinge	Lock	Thickness (mm)	Mounting Plate	Product Weight (kg)	Product Volume (m ³)
200 x 300 x 120 mm	2 pieces	1 piece	min 3-4	0,8	2,4	0,007

BOX CONTENTS

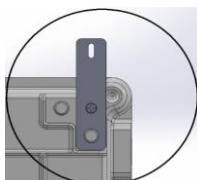

- Wall Hanging Clips (4 Pcs)
- M5x12 Phillips Head Screws (4 Pcs)
- Spanner (1 Pcs)
- Mounting plate

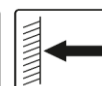
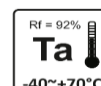

GRP PANELS

21 x 32 x 13 GRP Electrical Panel

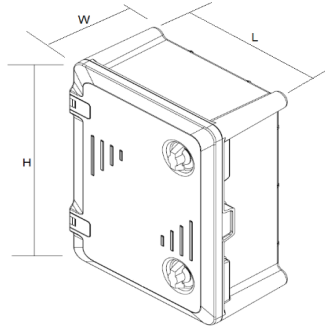

GENERAL SPECIFICATIONS

Raw Material	Glass Reinforced Polyester
Quality Standart	EN61439, EN60670-1
Color	RAL 7035
Operating Temperature	-40°C / +70°C
Rated Voltage	Up to 690 V
Maximum Current	Up to 800 A
Door Opening Angle	210°
Protection Class	IP65
IK Degree	Up to IK08
Mounting Plate	Galvanised Steel
Grounding Class	Class II
Fire Resistance	V0,V2,B2,A1,A2,B1 available

ADDITIONAL SPECIFICATIONS

Polyurathane Foam Gasket or EPDM Gasket
High Resistance Adverse Weather Conditions
Full Protection Against Acid and Base
UV Resistance
Lock types are optional

APPLICATIONS

Transformer Load Boards	Automation Panels
Compensation Boards	Control Panels
Distribution Boards	Lighting Panels
Network Generator	OSOS Panels
Transfer Applications	Counter Panels

PHYSICAL SPECIFICATIONS

Size	Code	W (mm)	H (mm)	L (mm)	Quantity / Pack	Volume (m ³)	Weight (kg)
21 x 32 x 13	EB6213213	130	320	210	8	0,087	40,8

PRODUCT SPECIFICATIONS

Size	Hinge	Lock	Thickness (mm)	Mounting Plate	Product Weight (kg)	Product Volume (m ³)
210 x 320 x 130 mm	2 pieces	1 piece	min 3-4	0,8	1,9	0,008

BOX CONTENTS

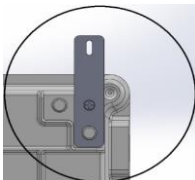

- Wall Hanging Clips (4 Pcs)
- M5x12 Phillips Head Screws (4 Pcs)
- Spanner (1 Pcs)
- Mounting plate

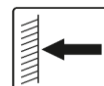
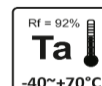

GRP PANELS

25 x 30 x 17 GRP Electrical Panel

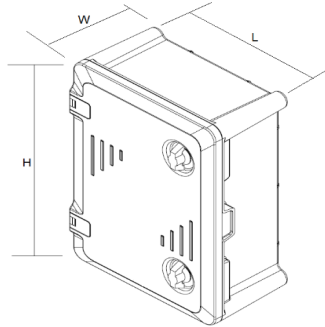

GENERAL SPECIFICATIONS

Raw Material	Glass Reinforced Polyester
Quality Standart	EN61439, EN60670-1
Color	RAL 7035
Operating Temperature	-40°C / +70°C
Rated Voltage	Up to 690 V
Maximum Current	Up to 800 A
Door Opening Angle	210°
Protection Class	IP65
IK Degree	Up to IK08
Mounting Plate	Galvanised Steel
Grounding Class	Class II
Fire Resistance	V0,V2,B2,A1,A2,B1 available

ADDITIONAL SPECIFICATIONS

Polyurathane Foam Gasket or EPDM Gasket
High Resistance Adverse Weather Conditions
Full Protection Against Acid and Base
UV Resistance
Lock types are optional

APPLICATIONS

Transformer Load Boards	Automation Panels
Compensation Boards	Control Panels
Distribution Boards	Lighting Panels
Network Generator	OSOS Panels
Transfer Applications	Counter Panels

PHYSICAL SPECIFICATIONS

Size	Code	W (mm)	H (mm)	L (mm)	Quantity / Pack	Volume (m ³)	Weight (kg)
25 x 30 x 17	EB6253017	170	300	250	6	0,090	29,8

PRODUCT SPECIFICATIONS

Size	Hinge	Lock	Thickness (mm)	Mounting Plate	Product Weight (kg)	Product Volume (m ³)
250 x 300 x 170 mm	2 pieces	1 piece	min 3-4	0,8	3,0	0,012

BOX CONTENTS

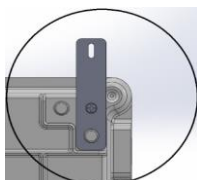

- Wall Hanging Clips (4 Pcs)
- M5x12 Phillips Head Screws (4 Pcs)
- Spanner (1 Pcs)
- Mounting plate



GRP PANELS

30 x 40 x 17 GRP Electrical Panel

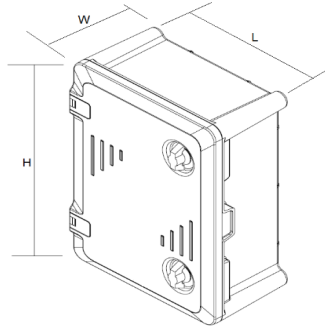

GENERAL SPECIFICATIONS

Raw Material	Glass Reinforced Polyester
Quality Standart	EN61439, EN60670-1
Color	RAL 7035
Operating Temperature	-40°C / +70°C
Rated Voltage	Up to 690 V
Maximum Current	Up to 800 A
Door Opening Angle	210°
Protection Class	IP65
IK Degree	Up to IK08
Mounting Plate	Galvanised Steel
Grounding Class	Class II
Fire Resistance	V0,V2,B2,A1,A2,B1 available

ADDITIONAL SPECIFICATIONS

Polyurathane Foam Gasket or EPDM Gasket
High Resistance Adverse Weather Conditions
Full Protection Against Acid and Base
UV Resistance
Lock types are optional

APPLICATIONS

Transformer Load Boards	Automation Panels
Compensation Boards	Control Panels
Distribution Boards	Lighting Panels
Network Generator	OSOS Panels
Transfer Applications	Counter Panels

PHYSICAL SPECIFICATIONS

Size	Code	W (mm)	H (mm)	L (mm)	Quantity / Pack	Volume (m ³)	Weight (kg)
30 x 40 x 17	EB6304017	170	400	300	4	0,099	26,7

PRODUCT SPECIFICATIONS

Size	Hinge	Lock	Thickness (mm)	Mounting Plate	Product Weight (kg)	Product Volume (m ³)
300 x 400 x 170 mm	2 pieces	2 pieces	min 3-4	0,8	4,7	0,020

BOX CONTENTS

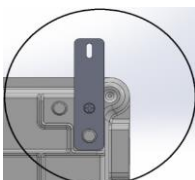

- Wall Hanging Clips (4 Pcs)
- M5x12 Phillips Head Screws (4 Pcs)
- Spanner (1 Pcs)
- Mounting plate

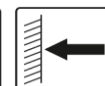
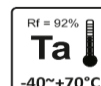

GRP PANELS

35 x 50 x 17 GRP Electrical Panel

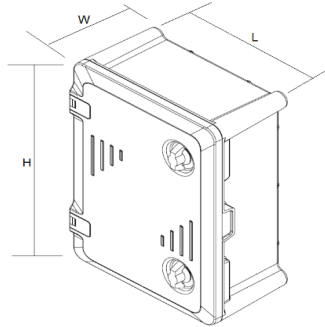

GENERAL SPECIFICATIONS

Raw Material	Glass Reinforced Polyester
Quality Standart	EN61439, EN60670-1
Color	RAL 7035
Operating Temperature	-40°C / +70°C
Rated Voltage	Up to 690 V
Maximum Current	Up to 800 A
Door Opening Angle	210°
Protection Class	IP65
IK Degree	Up to IK08
Mounting Plate	Galvanised Steel
Grounding Class	Class II
Fire Resistance	V0,V2,B2,A1,A2,B1 available

ADDITIONAL SPECIFICATIONS

Polyurathane Foam Gasket or EPDM Gasket
High Resistance Adverse Weather Conditions
Full Protection Against Acid and Base
UV Resistance
Lock types are optional

APPLICATIONS

Transformer Load Boards	Automation Panels
Compensation Boards	Control Panels
Distribution Boards	Lighting Panels
Network Generator	OSOS Panels
Transfer Applications	Counter Panels

PHYSICAL SPECIFICATIONS

Size	Code	W (mm)	H (mm)	L (mm)	Quantity / Pack	Volume (m ³)	Weight (kg)
35 x 50 x 17	EB6355017	170	500	350	2	0,067	17,4

PRODUCT SPECIFICATIONS

Size	Hinge	Lock	Thickness (mm)	Mounting Plate	Product Weight (kg)	Product Volume (m ³)
350 x 500 x 170 mm	2 pieces	2 pieces	min 3-4	0,8	6,4	0,030

BOX CONTENTS

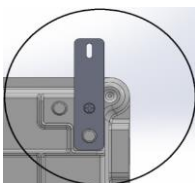

- Wall Hanging Clips (4 Pcs)
- M5x12 Phillips Head Screws (4 Pcs)
- Spanner (1 Pcs)
- Mounting plate

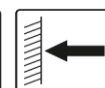
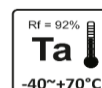

GRP PANELS

40 x 60 x 20 GRP Electrical Panel

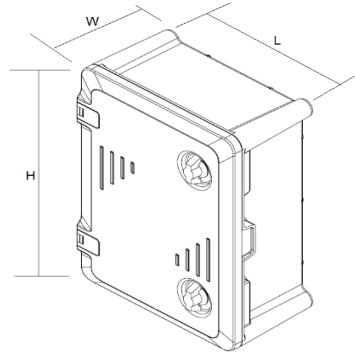

GENERAL SPECIFICATIONS

Raw Material	Glass Reinforced Polyester
Quality Standart	EN61439, EN60670-1
Color	RAL 7035
Operating Temperature	-40°C / +70°C
Rated Voltage	Up to 690 V
Maximum Current	Up to 800 A
Door Opening Angle	210°
Protection Class	IP65
IK Degree	Up to IK08
Mounting Plate	Galvanised Steel
Grounding Class	Class II
Fire Resistance	V0,V2,B2,A1,A2,B1 available

ADDITIONAL SPECIFICATIONS

Polyurathane Foam Gasket or EPDM Gasket
High Resistance Adverse Weather Conditions
Full Protection Against Acid and Base
UV Resistance
Lock types are optional

APPLICATIONS

Transformer Load Boards	Automation Panels
Compensation Boards	Control Panels
Distribution Boards	Lighting Panels
Network Generator	OSOS Panels
Transfer Applications	Counter Panels

PHYSICAL SPECIFICATIONS

Size	Code	W (mm)	H (mm)	L (mm)	Quantity / Pack	Volume (m ³)	Weight (kg)
40 x 60 x 20	EB6406020	200	600	400	1	0,055	13,2

PRODUCT SPECIFICATIONS

Size	Hinge	Lock	Thickness (mm)	Mounting Plate	Product Weight (kg)	Product Volume (m ³)
400 x 600 x 200 mm	2 pieces	2 pieces	min 3-4	1	9	0,048

BOX CONTENTS

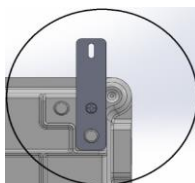

- Wall Hanging Clips (4 Pcs)
- M5x12 Phillips Head Screws (4 Pcs)
- Spanner (1 Pcs)
- Mounting plate

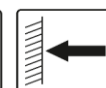
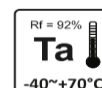

GRP PANELS

50 x 70 x 20 GRP Electrical Panel

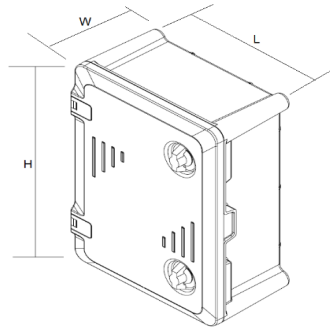

GENERAL SPECIFICATIONS

Raw Material	Glass Reinforced Polyester
Quality Standart	EN61439, EN60670-1
Color	RAL 7035
Operating Temperature	-40°C / +70°C
Rated Voltage	Up to 690 V
Maximum Current	Up to 800 A
Door Opening Angle	210°
Protection Class	IP65
IK Degree	Up to IK08
Mounting Plate	Galvanised Steel
Grounding Class	Class II
Fire Resistance	V0,V2,B2,A1,A2,B1 available

ADDITIONAL SPECIFICATIONS

Polyurathane Foam Gasket or EPDM Gasket
High Resistance Adverse Weather Conditions
Full Protection Against Acid and Base
UV Resistance
Lock types are optional

APPLICATIONS

Transformer Load Boards	Automation Panels
Compensation Boards	Control Panels
Distribution Boards	Lighting Panels
Network Generator	OSOS Panels
Transfer Applications	Counter Panels

PHYSICAL SPECIFICATIONS

Size	Code	W (mm)	H (mm)	L (mm)	Quantity / Pack	Volume (m ³)	Weight (kg)
50 x 70 x 20	EB6507020	200	700	500	1	0,082	17,7

PRODUCT SPECIFICATIONS

Size	Hinge	Lock	Thickness (mm)	Mounting Plate	Product Weight (kg)	Product Volume (m ³)
500 x 700 x 200 mm	3 pieces	2 pieces	min 4-5	1	12	0,070

BOX CONTENTS

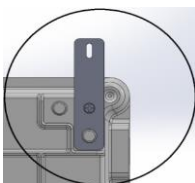

- Wall Hanging Clips (4 Pcs)
- M5x12 Phillips Head Screws (4 Pcs)
- Spanner (1 Pcs)
- Mounting plate

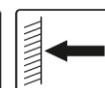
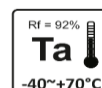

GRP PANELS

60 x 80 x 22 GRP Electrical Panel

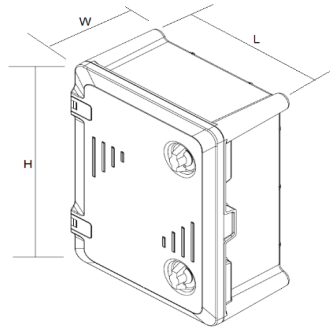

GENERAL SPECIFICATIONS

Raw Material	Glass Reinforced Polyester
Quality Standart	EN61439, EN60670-1
Color	RAL 7035
Operating Temperature	-40°C / +70°C
Rated Voltage	Up to 690 V
Maximum Current	Up to 800 A
Door Opening Angle	210°
Protection Class	IP65
IK Degree	Up to IK08
Mounting Plate	Galvanised Steel
Grounding Class	Class II
Fire Resistance	V0,V2,B2,A1,A2,B1 available

ADDITIONAL SPECIFICATIONS

Polyurathane Foam Gasket or EPDM Gasket
High Resistance Adverse Weather Conditions
Full Protection Against Acid and Base
UV Resistance
Lock types are optional

APPLICATIONS

Transformer Load Boards	Automation Panels
Compensation Boards	Control Panels
Distribution Boards	Lighting Panels
Network Generator	OSOS Panels
Transfer Applications	Counter Panels

PHYSICAL SPECIFICATIONS

Size	Code	W (mm)	H (mm)	L (mm)	Quantity / Pack	Volume (m ³)	Weight (kg)
60 x 80 x 22	EB6608022	220	800	600	1	0,132	38,2

PRODUCT SPECIFICATIONS

Size	Hinge	Lock	Thickness (mm)	Mounting Plate	Product Weight (kg)	Product Volume (m ³)
600 x 800 x 220 mm	3 pieces	2 pieces	min 4-5	1	17	0,100

BOX CONTENTS

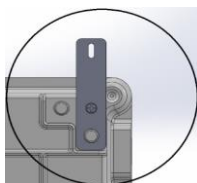

- Wall Hanging Clips (4 Pcs)
- M5x12 Phillips Head Screws (4 Pcs)
- Spanner (1 Pcs)
- Mounting plate

